

150520 Mini Series

In-Line Fuseholder for 5×20mm Fuses



Description

The 150520 In-Line fuseholder is rated at 20A with rated voltage 600 VAC / VDC ideal for applications where supplemental protection is needed, such as Data Centers, HVAC and Power Supplies. Eight-inch pre-stripped wire leads and fuse clips come preassembled for quick installation.

Features & Benefits

- High voltage rating accomodates many power applications
- Wire leads are pre-attached to fuse clips for quick assembly
- Single piece molded body
- UL Recognized to UL / CSA 4248.1

Agency Approvals

Agency	Agency File Number
	E14721

Product Characteristics

Voltage Rating	600 VAC / VDC
Ampere Rating	20 A
Fuse Type	5 X 20 mm
Fuse Clips	Tin-plated brass
Wire	14 AWG UL3321, XLPE Insulated, Red Color
Molded Body	Single piece thermoplastic
Flammability Rating	UL94 V-0
Environmental	RoHS compliant and Pb free
Storage Temperature	-40 °C to 80 °C
Operating Temperature	-40 °C to 105 °C
Ingress Protection	IP40

Note: Refer to Fuseology for information on proper fuseholder re-rating.

Product Dimensions

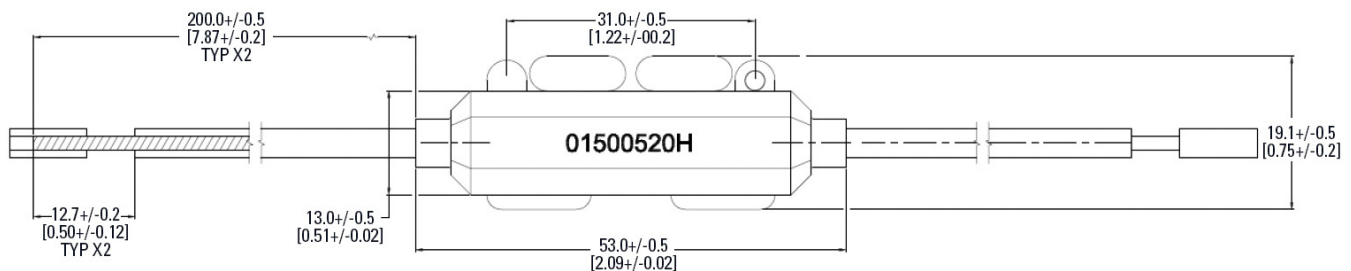

Warning: Electrical Shock. Power must be disconnected prior to handling fuse.

Ordering Information

Ordering PN	Current	Voltage	Terminal Material	Plating	Wire Range AWG	Packaging
01500520H	20 A	600 VAC / VDC	Copper Alloy	Tin Plated	16-22	100 pcs (bulk)

Disclaimer Notice - Information furnished is believed to be accurate and reliable. However, users should independently evaluate the suitability of and test each product selected for their own applications. Littelfuse products are not designed for, and may not be used in, all applications. Read complete Disclaimer Notice at <http://www.littelfuse.com/disclaimer-electronics>.